

Home

Magnetic Assemblies

Specification of Magnets

Ferrite Magnet

NdFeB Magnet

SmCo Magnet

Alnico Magnet

Process pieces

Other products

## Specification of Magnets >> Ferrite Magnet

### Isotropic Ba-Ferrite Magnet

Round Type | Round Top Type | Ring Type | Square Type | Pierced Square Type

Beads Type (Ball) | Beads Type

#### Round Type

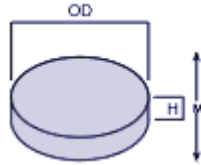

| OD × H    |
|-----------|
| 3.6 Φ × 3 |
| 5 Φ × 3   |
| 6 Φ × 3.4 |
| *6 Φ × 8  |
| 8 Φ × 2.5 |
| 8 Φ × 4   |
| 10 Φ × 2  |
| 10 Φ × 3  |

| OD × H   |
|----------|
| 10 Φ × 5 |
| 10 Φ × 6 |
| 10 Φ × 8 |
| 12 Φ × 4 |
| 15 Φ × 3 |
| 15 Φ × 4 |
| 15 Φ × 7 |
| 17 Φ × 4 |

| OD × H     |
|------------|
| 20 Φ × 3   |
| 20 Φ × 4   |
| 21.5 Φ × 4 |
| 24 Φ × 8.5 |
| 25 Φ × 4   |
| 25 Φ × 5   |
| 30 Φ × 5   |

\*Ni Plated

[To page top](#) ↑

#### Round Top Type

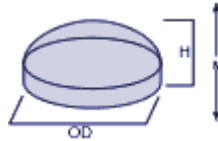

| OD × H    |
|-----------|
| 10 Φ × 4R |
| 12 Φ × 6R |
| 20 Φ × 8R |

[To page top](#) ↑

#### Ring Type

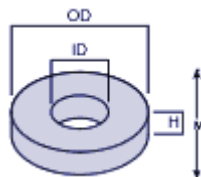

| OD × ID × H        |
|--------------------|
| 8Φ × 5Φ × 3.5      |
| 12.3Φ × 4.5Φ × 2.2 |
| 10.6Φ × 3Φ × 6     |
| 11.5Φ × 7Φ × 4     |
| 12Φ × 3Φ × 8       |
| 13Φ × 8Φ × 3       |
| 15Φ × 5Φ × 4       |
| 15Φ × 10Φ × 5      |
| 18.5Φ × 2.5Φ × 4.5 |
| 19Φ × 6.5Φ × 10    |
| 20Φ × 7Φ × 4       |

| OD × ID × H        |
|--------------------|
| 20Φ × 7Φ (4Φ) × 4  |
| 22Φ × 6.2Φ × 6     |
| 22Φ × 12.7Φ × 7    |
| 25Φ × 12.8Φ × 12.7 |
| 27.5Φ × 5.8Φ × 3.3 |
| 30Φ × 10Φ × 10     |
| 33Φ × 22Φ × 5      |
| 38Φ × 9Φ × 5.7     |
| 38Φ × 28Φ × 5      |
| 44Φ × 18Φ × 6      |
| 50Φ × 20Φ × 10     |

[To page top](#) ↑

#### Square Type

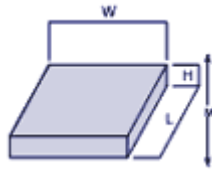

|                  |
|------------------|
| 19.7 × 12.7 × 6  |
| 20 × 8 × 3       |
| 20 × 10 × 4      |
| 20 × 14 × 3.8    |
| 23.5 × 7.7 × 4.8 |
| 24 × 10 × 3.8    |
| 24 × 10 × 5      |
| 25 × 8 × 5       |
| 25 × 19 × 4.8    |
| 26 × 12.7 × 3.8  |
| 28 × 11 × 5      |
| 30 × 10 × 3      |

|               |
|---------------|
| 35 × 8.5 × 5  |
| 40 × 13 × 5.4 |
| 48 × 10 × 7   |
| 50 × 8 × 7    |
| 50 × 10 × 10  |
| 50 × 14 × 10  |
| 50 × 19 × 3.2 |
| 59 × 6 × 12.5 |
| 59 × 10.6 × 6 |
| 60 × 14 × 5.5 |
| 60 × 30 × 5   |

[To page top](#) ↑

#### Pierced Square Type

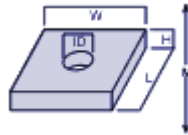

| L × W × H [ ID ]      |
|-----------------------|
| 13.8 × 8.8 × 4 (3.2Φ) |
| 20 × 14 × 3.8 (4Φ)    |
| 24 × 11 × 4 (5Φ)      |
| 25 × 19 × 3.8 (5Φ)    |

[To page top](#) ↑

#### Beads Type (Ball)

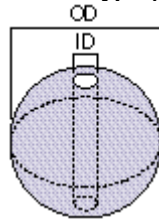

| OD × ID    | Remarks        |
|------------|----------------|
| 4Φ × 1.5Φ  | Black Polished |
| 6Φ × 1.5Φ  | Black Polished |
| 6Φ × 1.5Φ  | Gold plated    |
| 8Φ × 1.5Φ  | Black Polished |
| 10Φ × 1.5Φ | Black Polished |

[To page top](#) ↑

#### Beads Type

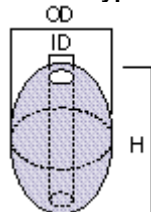

| OD × ID × H    | Remarks        |
|----------------|----------------|
| 8Φ × 1.5Φ × 12 | Black Polished |