

Magnetic Assemblies >> Permanent Magnet Lifter

- ❖ [Home](#)
- ❖ [Magnetic Assemblies](#)
 - [Assembling Suspension](#)
 - [Pot Magnet](#)
 - [Magnetic stand](#)
 - [Magnetic Chuck](#)
 - [Magnetic Sweepers](#)
 - [Pull-and-Push Magnetic Attractor](#)
 - [Magnetic door suction](#)
 - [Magnetic Separator](#)
 - [Lifting Magnets](#)
- ❖ [Specification of Magnets](#)
- ❖ [Process Pieces](#)
- ❖ [Other Products](#)

Permanent Magnet Lifter

Powered by strongest NdFeB Permanent Magnet and with our unique design, our lifter has below features:

1. Small and most compact.
2. No need of electricity and no dangerous from sudden cut off of electricity.
3. No damage to contacting surface of lifted objects.
4. The position of magnetism on/off switch is secured by a BUTTON.
5. With a V shape slot through the center of holding surface, both round and flat steel objects can be lifted.
6. Safety Factor of all types is 3.5 Minimum.

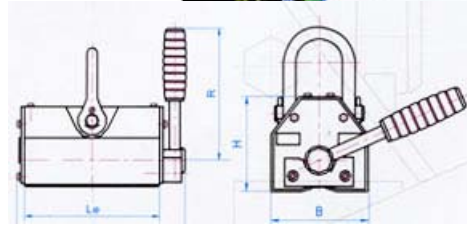
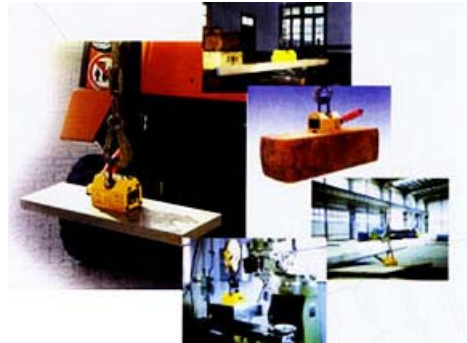

P/N	Rated Lifting Strength (KG)	Pull-off Strength (KG)	L (mm)	B (mm)	H (mm)	R (mm)	Max Working Temperature (°C)	Weight (KG)
XML-01-01	100	350	62	92	67	126	80	3
XML-01-02	300	1050	92	162	91	155	80	10
XML-01-03	600	2100	122	232	117	196	80	24
XML-01-04	1000	3500	176	258	163	285	80	50
XML-01-05	2000	7000	234	378	212	426	80	125
XML-01-06	3000	10500	286	458	261	521	80	220
XML-01-07	6000	21000	430	600	355	180	80	420

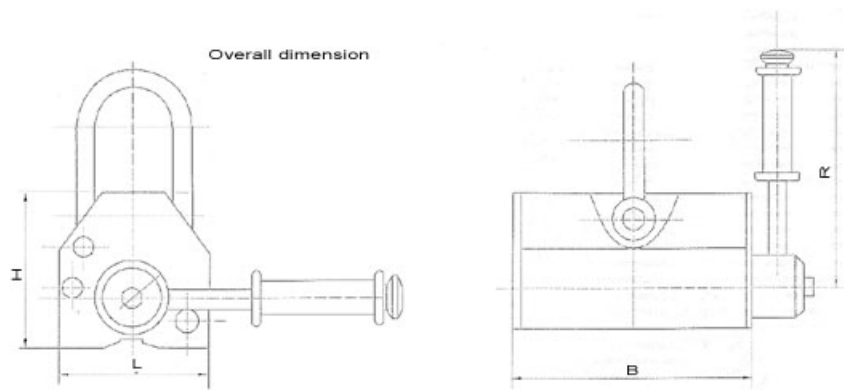

[LWM-1 Lifting Magnets](#) | [Permanent Magnet Lifter](#)